

PULSAtron Series HV

The Pulsatron Series HV designed for high viscosity applications for precise and accurate metering control. The Series HV offers manual control over stroke length and stroke rate as standard with the option to choose between 4-20mA and external pace inputs for automatic control.

Five distinct models are available, having pressure capabilities to 150 PSIG (10 BAR) @ 12 GPD (1.9 lph), and flow capacities to 240 GPD (37.9 lph) @ 80 PSIG (5.6 BAR), with a turndown ratio of 100:1. Metering performance is reproducible to within $\pm 2\%$ of maximum capacity.

FEATURES

- Automatic Control, available with 4-20mADC direct or external pacing, with stop function.
- Manual Control by on-line adjustable stroke rate and stroke length.
- Auto-Off Manual switch.
- Highly Reliable timing circuit.
- Circuit Protection against voltage and current upsets.
- Solenoid Protection by thermal overload with auto-reset.
- Water Resistant, for outdoor and indoor applications.
- Indicator Lights, panel mounted.
- Guided Ball Check Valve Systems, to reduce back flow and enhance outstanding priming characteristics.
- Viscosities to 20,000 CPS.



BENEFITS

- Reliable metering performance.
- Rated "hot" for continuous duty.
- High viscosity capability.
- Leak-free, sealless, liquid end.

CONTROLS

Manual Stroke Rate

- Turn-Down Ratio 10:1

Manual Stroke Length

- Turn-Down Ratio 10:1

4-20mADC Direct or External Pacing with Stop

- Automatic Control



Tested and Certified by WQA
against NSF/ANSI/CAN 61 & 372.



PVDF & PVC Degass Head Pumps.
See www.wqa.org for
certification parameters.



SPECIFICATIONS

MODEL		LVB3	LVF4	LVG4	LVG5	LVH7
Capacity nominal (max.)	GPH	0.50	1.00	2.00	4.00	10.00
	GPD	12	24	48	96	240
	LPH	1.9	3.8	7.6	15.1	37.9
Pressure (max.)	PSIG	150	150	110	110	80
	BAR	10	10	7	7	5.6
Connections:	Tubing	(S) .50" I.D. X .75" O.D. .38" I.D. X .50" OD (LVB3 & F4 only) (S & D) .50" I.D. X .75" O.D. (LVG4, G5 & H7 only)				

ENGINEERING DATA

Pump Head Materials Available	GFPPL, PVC
Diaphragm	PTFE-faced CSPE-backed
Check Valves Materials Available	
Seats/O-Rings	PTFE, CSPE, Viton
Balls	PTFE, 316 SS, Alloy C
Fittings Materials Available	GFPPL, PVC
Injection Valve & Foot Valve Assy	Same as fitting and check valve selected
Tubing	Clear PVC, White PE

Important: Material Code - GFPPL=Glass-filled Polypropylene, PVC=Polyvinyl Chloride, PE=Polyethylene, PVDF=Polyvinylidene Fluoride, CSPE=Generic formulation of Hypalon, a registered trademark of E.I. DuPont Company. Viton is a registered trademark of E.I. DuPont Company. PVC wetted end recommended for sodium hypochlorite.

Reproducibility	±2% at maximum capacity
Viscosity Max CPS	20,000 CPS
Stroke Frequency Max SPM	125
Stroke Frequency Turn-Down Ratio	10:1
Stroke Length Turn-Down Ratio	10:1
Power Input	115 VAC / 50-60 HZ / 1 ph 230 VAC / 50-60 HZ / 1 ph
Average Current Draw	
@ 115 VAC: Amps	1.0 Amps
@230 VAC: Amps	0.5 Amps
Peak Input Power	300 Watts
Average Input Power @ Max SPM	130 Watts
Approvals	Conforms to ANSI/NSF STD. 50

DIMENSIONS

Series HV Dimensions (inches)					
Model No.	A	B	C	D	Shipping Weight
LVB3	5.4	9.3	9.5	7.5	13 lbs.
LVF4	5.4	10.8	10.8	7.5	18 lbs.
LVG4	5.4	9.5	10.6	7.5	18 lbs.
LVG5	5.4	10.8	10.8	7.5	18 lbs.
LVH7	6.1	11.5	11	8.2	25 lbs.

NOTE: Inches X 2.54 = cm

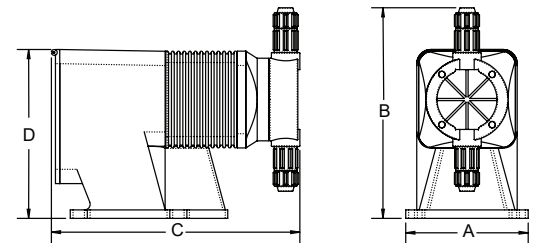

PULSAFEEDER®

27101 Airport Road
Punta Gorda, FL 33982

Tel: (941) 575-3800

Fax: (941) 575-4085

www.pulsatron.com

novatech
INTERNATIONAL

sales@novatech-usa.com

www.novatech-usa.com

Tel: (866) 433-6682

Tel: (281) 359-8538

Fax: (866) 433-6684

Fax: (281) 359-0084



An ISO Certified Company

IBEX
EMP033 A22