

## 1 1/2" & 2" DIAPHRAGM HEAD PARTS

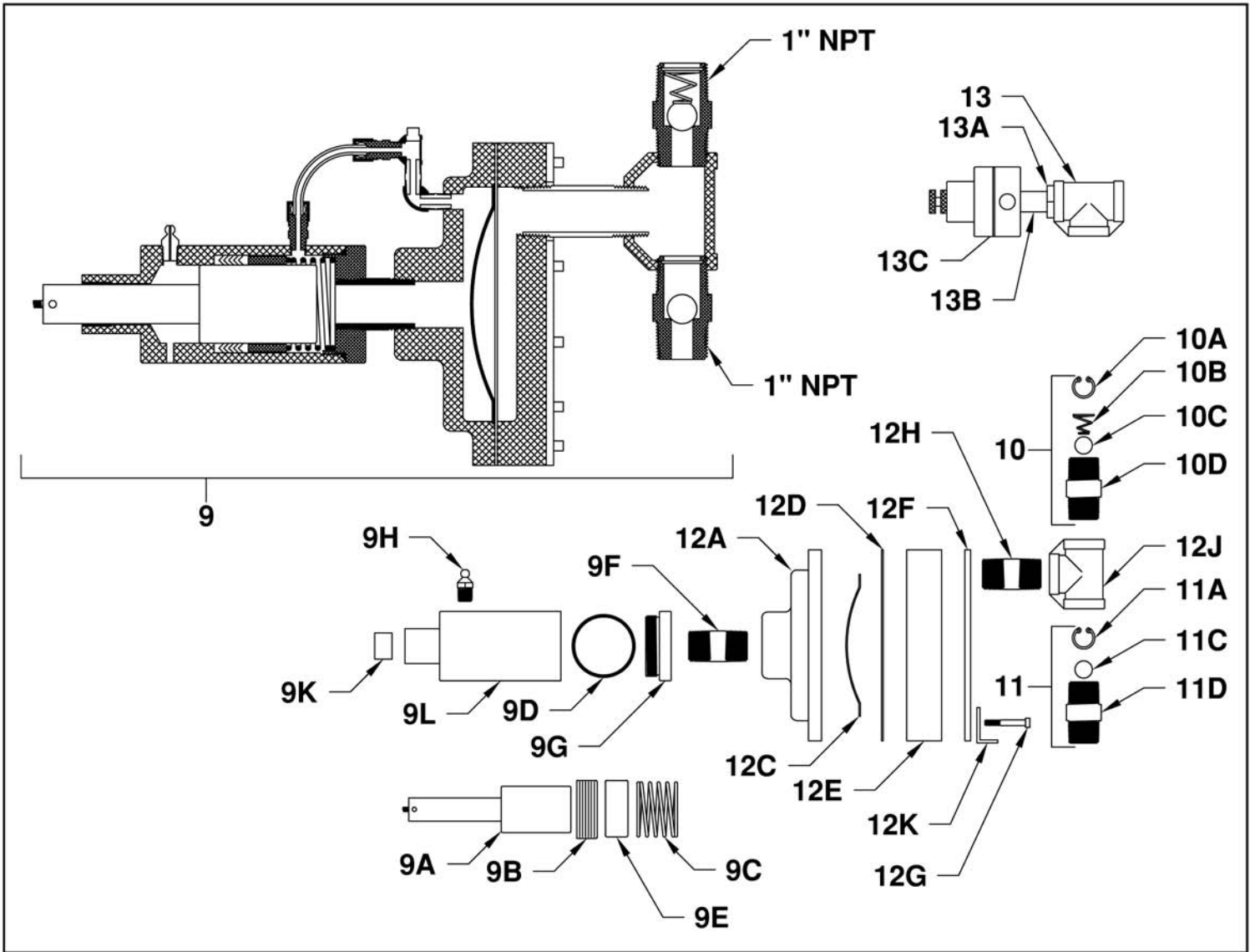

ITEM	PART #	DESCRIPTION
9	0100-7	1 1/2" POLYETHYLENE PUMP HEAD ASSEMBLY W/CHECKS***
	0100-8	2" POLYETHYLENE PUMP HEAD ASSEMBLY W/CHECKS***
9A	007-8	1 1/2" DIAMETER 303SS PISTON
	007-9	2" DIAMETER 303SS PISTON
9B	012-8	1 1/2" PACKING SET (BUNA N)
	012-9	2" PACKING SET (BUNA N)
9C	017-20	1 1/2" & 2" PACKING SPRING
9D	017-21	2 1/2" ID X 1/8" DIAMETER "O" RING SEAL
9E	018-1	1 1/2" PACKING SPACER
	018-2	2" PACKING SPACER
9F	002-13	1" NPT X CLOSE BLACK NIPPLE
9G	003-20	1 1/2" & 2" CARBON STEEL END CAP
9H	006-1	GREASE FITTING
9K	008-20	1 1/8" X 1" X 3/4" LONG OILITE BUSHING
9L	001-20	1 1/2" & 2" PUMP HEAD SHELL
10*	002-22P-D	POLYETHYLENE DISCHARGE CHECK VALVE ASSEMBLY
	002-19-D	303SS DISCHARGE CHECK VALVE ASSEMBLY**
10A	16-SS	SS SNAP RING BALL RETAINER
10B	002-27	ANTI-SIPHON SPRING CONE SPRING ALLOY 276
10C	007-20	3/4" DIAMETER CERAMIC BALL CHECK
	002-17	3/4" DIAMETER 316SS BALL CHECK
10D	002-30	POLYETHYLENE CHECK VALVE BODY
	002-18	303SS CHECK VALVE BODY

\* RECOMMENDED SPARE PARTS

ITEM	PART #	DESCRIPTION
11*	002-22P-S	POLYETHYLENE SUCTION CHECK VALVE ASSEMBLY
	002-19-S	303SS SUCTION CHECK VALVE ASSEMBLY**
11A	16-SS	SS SNAP RING BALL RETAINER
11C	007-20	3/4" DIAMETER CERAMIC BALL CHECK
	002-17	3/4" DIAMETER 316SS BALL CHECK
11D	002-30	POLYETHYLENE CHECK VALVE BODY
	002-18	303SS CHECK VALVE BODY
12A	001-H20	1 1/2" & 2" HYDRAULIC HEAD CASTING
12C	030-2H	SCREEN
12D	026-2H	1 1/2" & 2" HYDRAULIC HEAD TEFLON DIAPHRAGM
12E	025-H20	1 1/2" & 2" POLYETHYLENE HYDRAULIC HEAD (STANDARD)
	025-H20-S	1 1/2" & 2" 303SS HYDRAULIC HEAD
12F	029-H20	POLYETHYLENE PUMP HEAD CLAMP PLATE
12G	027-H20	HEAD BOLTS (12 REQUIRED)
12H	002-13-P	1" NPT X SHORT PVC NIPPLE
	002-13-S	1" NPT X SHORT 316SS NIPPLE
12J	002-12-P	1" NPT PVC TEE
	002-12-S	1" 316SS TEE
12K	031	HEAD SUPPORT LEG
13	002-12-P	1" NPT PVC TEE
13A		1/2" NPT X 1" NPT PVC BUSHING
13B		1/2" NPT X 1 1/2" PVC NIPPLE
13C	36P	1/2" NPT POLYETHYLENE PRESSURE RELIEF VALVE

OPTIONAL MATERIALS

- \*\* 316SS
- \*\*\* 303SS
- \*\*\* 316SS

## **WARRANTY ON EQUIPMENT SUPPLIED BY A&F MACHINE PRODUCTS COMPANY**

A&F Machine Products Company (A&F) warrants the components and workmanship of its products under normal use and service for a period of one year from date of shipment. All obligations and liabilities assumed under this warranty are limited to the repair or replacement, at our option, FOB A&F, of defective units that are returned. Improper use, application, or service voids all warranties. In any event, A&F shall not be liable for indirect or consequential damages arising out of the use of this equipment.

Warranty on equipment and accessories furnished by A&F, but not manufactured by A&F, shall be limited to the warranty of the respective equipment or accessory manufacturer for such units. In any event, A&F shall not be liable for indirect or consequential damages arising out of the provision or use of this equipment or accessory.

### **Shipping is FOB A&F Machine Products Co. in Berea, Ohio**

#### **FEDEX GROUND AND FEDEX AIR**

MOST ORDERS LESS THAN 90# WILL BE SHIPPED VIA FEDEX GROUND, OR AIR IF SPECIFIED. WE DO NOT USE UPS. WE WILL SHIP PREPAY AND ADD UNLESS YOU SUPPLY A FEDEX ACCOUNT NUMBER. ORDERS OVER 90# WILL BE SHIPPED BY MOTOR FREIGHT.

#### **MOTOR FREIGHT**

ORDERS SHIPPED BY MOTOR FREIGHT ARE SHIPPED COLLECT OR BILLED TO A THIRD PARTY. PLEASE SPECIFY ON YOUR ORDER ANY PREFERENCE IN CARRIERS. ANY ORDER SHIPPED "PREPAID & ADD" WILL BE SUBJECT TO A \$30 HANDLING FEE.

#### **EXPEDITE FEE**

ALL PUMPS ARE CUSTOM BUILT PER ORDER. NORMALLY PUMP AND PACKAGED SYSTEM ORDERS ARE SHIPPED WITHIN 2 TO 3 DAYS AFTER RECEIPT OF THE ORDER. PUMP ORDERS REQUESTING SAME DAY OR NEXT DAY SHIPPING WILL BE HANDLED ON A FIRST COME FIRST SERVE BASIS AND WILL BE SUBJECT TO AN EXPEDITE FEE OF 25% OF THE INVOICE TOTAL. MOST PARTS ORDERS ARE SHIPPED FROM STOCK THE SAME DAY THEY ARE ORDERED. THERE IS A \$25 MINIMUM ON PARTS ORDERS.

#### **RETURNS**

EQUIPMENT THAT IS RETURNED FOR CREDIT IS SUBJECT TO INSPECTION BEFORE ANY CREDIT WILL BE ISSUED. GENERALLY, NEW AND UNUSED CATALOG ITEMS RECEIVED BACK AT A&F IN NEW AND UNUSED CONDITION IN IT'S ORIGINAL PACKAGING WILL BE SUBJECT TO A 15% RESTOCKING FEE. DAMAGED OR INCOMPLETE EQUIPMENT WILL BE CREDITED ACCORDINGLY. SPECIAL ORDER ITEMS OR ITEMS NOT LISTED IN THE CATALOG MAY NOT BE ELIGIBLE FOR CREDIT. ITEMS OR EQUIPMENT RETURNED FOR CREDIT MUST BE RETURNED FREIGHT PREPAID OR THEY WILL NOT BE ACCEPTED.



[sales@novatech-usa.com](mailto:sales@novatech-usa.com)

[www.novatech-usa.com](http://www.novatech-usa.com)

Tel: (866) 433-6682

Fax: (866) 433-6684

Tel: (281) 359-8538

Fax: (281) 359-0084